



PRESCOTT COMMUNICATIONS INC.
10640 Sepulveda Blvd. #1 • Mission Hills, CA 91345 • (800) 488-2352

Date: June 29, 2011

Memorandum to: Utility Coordinator

Memorandum from: Terry Ortega

Subject: Substructure Maps

Cable Engineering Services is currently researching and engineering a project for Black & Veatch. For the purpose of completing our underground route, we are requesting the following utility underground substructure maps.

Thomas Guide page & grid:
Los Angeles 589-D3

Locations:

Starting at Mali Vista Dr continuing 250' North
Please see highlighted Thomas Guide.

We are aware that there may be a charge for this service. **Please refer to our project No. 28500144-15** on the billing and any other correspondence regarding this job. Send all records and billing to:

CABLE ENGINEERING SERVICES
10640 Sepulveda Boulevard, Suite 1
Mission Hills, CA 91345
Attn: TERRY ORTEGA

Thank you for your assistance in this matter.

Sincerely,
Terry Ortega
Cable Engineering Services
Desk (818)898-2352
Cell (818)489-5288
Fax (818)898-9186
Terry.Ortega@cableeng.com

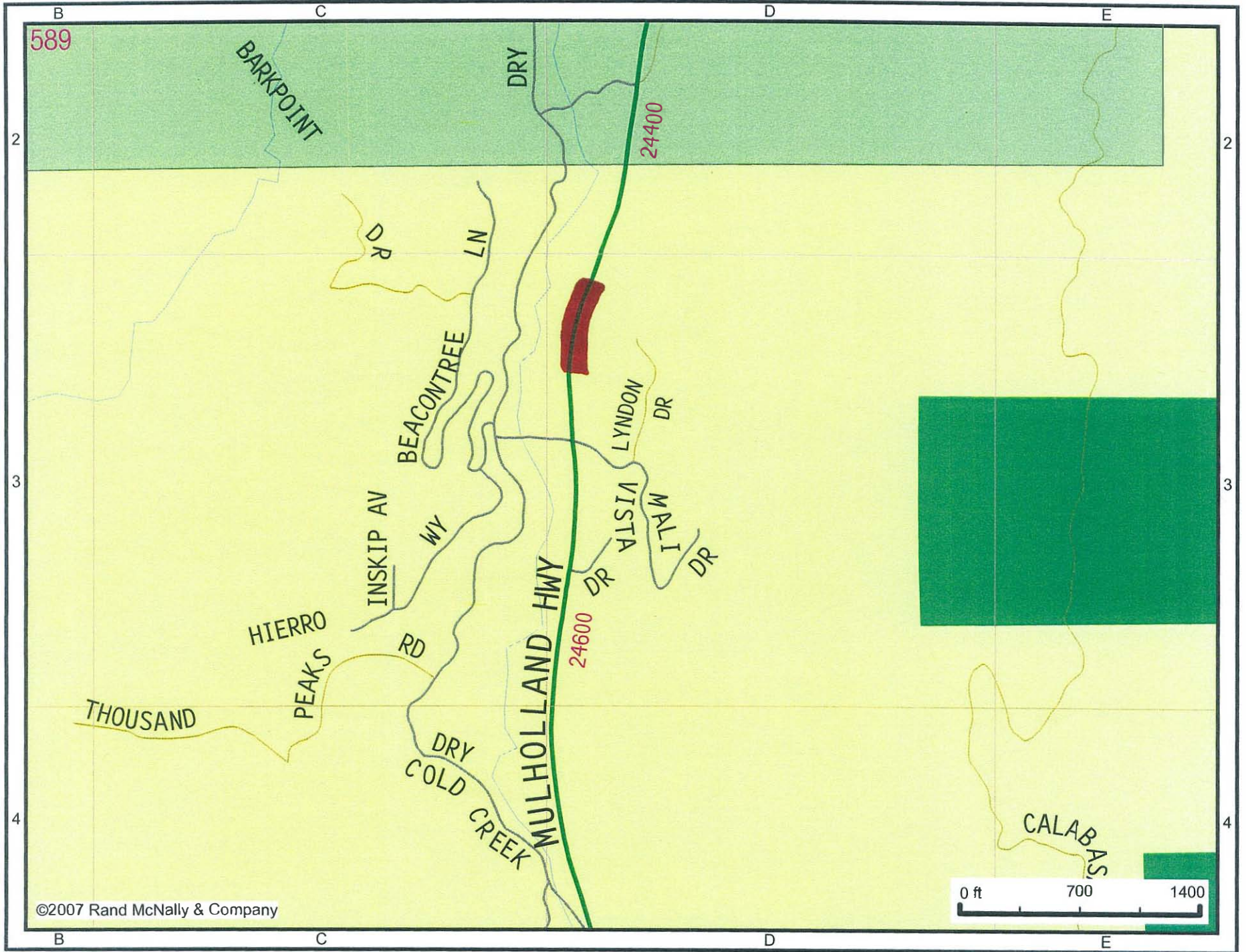

©2007 Rand McNally & Company

