



Rain Garden Plan



Plant Legend

- 1 Aquilegia chrysantha
- 2 Aster chilensis 'Point St. George'
- 3 Carex divulsa
- 4 Carex spissa
- 5 Carex texensis
- 6 Chondropetalum tectorum 'El Campo'
- 7 Epilobium canum 'Summer Snow'
- 8 Juncus patens 'Elk Blue'
- 9 Muhlenbergia dubia
- 10 Muhlenbergia lindheimeri 'Autumn Glow'
- 11 Zephyranthes candida

Key Map

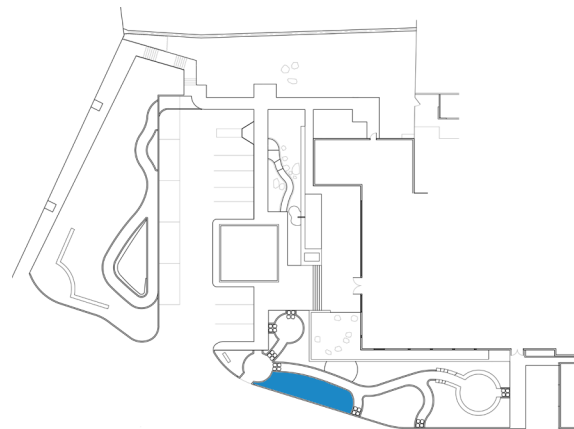

Plants for a rain garden are adapted to both wet and dry conditions.

At the bottom of the basin, use plants that can sit in water for several days such as Rushes, Sedges and Yerba Mansa.

On the sides and around the perimeter berms, you can place flowering plants that don't mind having their roots in wet soil temporarily such as Columbine or Ground Morning Glory.

 California native plant

